

HRM3000K1

F-20 POSTE

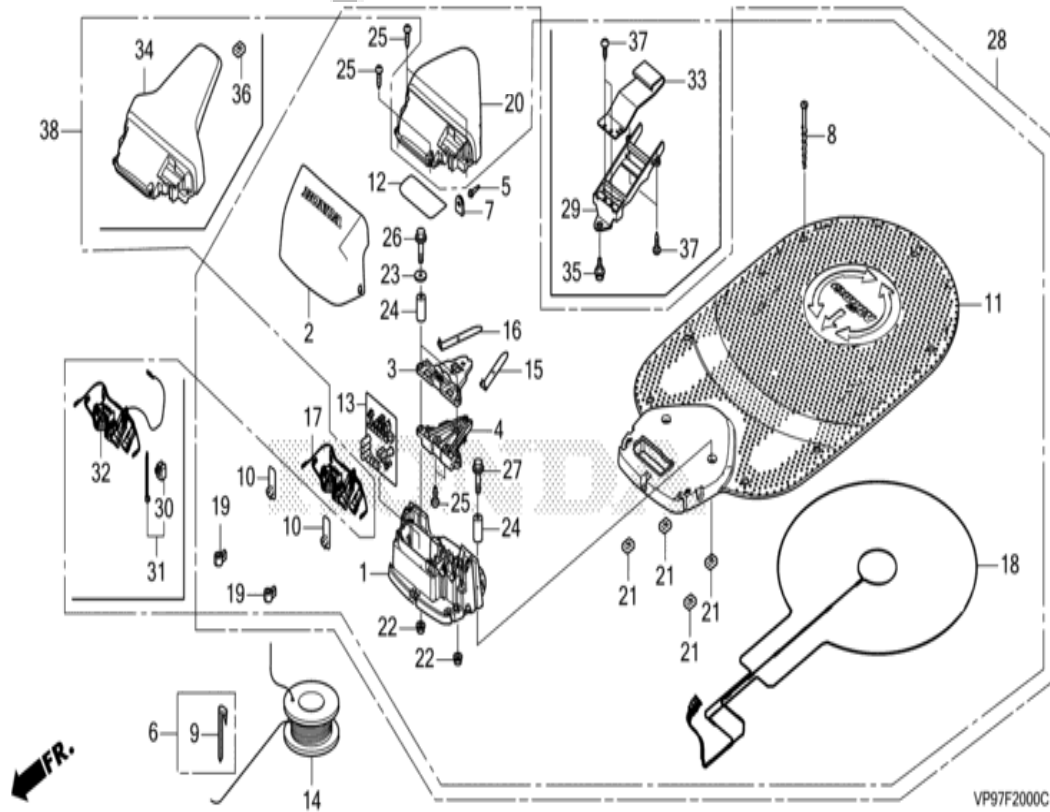

| n° de référence | référence | Description | à partir de | jusqu'à | Qte unitaire | Qté commandée | Qté réparation |
|-----------------|----------------|-------------------------------------|-------------|---------|--------------|---------------|----------------|
| 1 | 31220-VP9-000 | POSTE | | | 001 | 0 | 0 |
| 2 | 31221-VP9-A10 | COUVERCLE, POSTE | | | 001 | 0 | 0 |
| 3 | 31222-VP9-000 | COUVERCLE, SUP. PRISE CHARGE | | | 001 | 0 | 0 |
| 4 | 31223-VP9-000 | COUVERCLE, INF. PRISE CHARGE | | | 001 | 0 | 0 |
| 5 | 31224-VP7-000 | LENTILLE, INDICATEUR POSTE | | | 001 | 0 | 0 |
| 6 | 31225-VP7-000 | JEU CHEVILLES, FIL ZONE (50 PIECES) | | | (1) | 0 | 0 |
| 7 | 31226-VP7-000 | RONDELLE, LENTILLE INDICATEUR | | | 001 | 0 | 0 |
| 8 | 31227-VP7-000 | CHEVILLE, POSTE | | | 007 | 0 | 0 |
| 9 | 31228-VP7-000 | CHEVILLE, FIL ZONE | | | (50) | 0 | 0 |
| 10 | 31232-VP9-000 | BASE, CONNECTEUR | | | 002 | 0 | 0 |
| 11 | 31233-VP9-000 | PLAQUE, STATION | | | 001 | 0 | 0 |
| 12 | 31251-VP9-000 | JOINT, POSTE | | | 001 | 0 | 0 |
| 13 | 31570-VP9-013 | ENS. PCB, POSTE | | | 001 | 0 | 0 |
| 14 | 31575-VP7-000 | FIL, ZONE (300M) (2.3MM) | | | (1) | 0 | 0 |
| 14 | 31575-VP7-750 | FIL, ZONE (200M) (2.3MM) | | | (1) | 0 | 0 |
| 14 | 31575-VP9-PA0 | FIL, ZONE (500M) (2.7MM) | | | (1) | 0 | 0 |
| 15 | 31576-VP7-000 | PRISE, CHARGE | | | 001 | 0 | 0 |
| 16 | 31576-VP7-000 | PRISE, CHARGE | | | 001 | 0 | 0 |
| 18 | 31578-VP9-A10 | ENS. FAISCEAU, SIGNAL | | | 001 | 0 | 0 |
| 19 | 31579-VP9-000 | MANCHON (BLEU) | | | 002 | 0 | 0 |
| 21 | 90301-VP7-000 | ECROU SPECIAL, 6MM | | | 004 | 0 | 0 |
| 22 | 90302-VP7-000 | ECROU DE BRIDE, 6MM | | | 002 | 0 | 0 |
| 23 | 90401-ZA0-000 | RONDELLE PLATE, 6.5X15 | | | 002 | 0 | 0 |
| 24 | 91557-Z28-300 | COLLIER, POIGNEE TRANSPORT | | | 006 | 0 | 0 |
| 25 | 93913-15420 | VIS AUTO-TARAUDEUSE, 5X16 (PO) | | | 006 | 0 | 0 |
| 26 | 95701-06032-00 | BOULON DE BRIDE, 6X32 | | | 002 | 0 | 0 |
| 27 | 95701-06032-07 | BOULON DE BRIDE, 6X32 | | | 004 | 0 | 0 |
| 29 | 31229-VP9-A10 | BASE, SUP. FICHE CHARGE | | | 001 | 0 | 0 |
| 30 | 31571-VP9-A11 | BANDE | | | 002 | 0 | 0 |
| 31 | 31572-VP9-A11 | CIRCLIP, BANDE | | | 002 | 0 | 0 |
| 32 | 31577-VP9-PA0 | ENS. FAISCEAU, POSTE | | | 001 | 0 | 0 |
| 33 | 31586-VP9-A10 | FICHE, SUP. CHARGE | | | 001 | 0 | 0 |
| 34 | 32351-VP9-A10 | COUVERCLE, BOITIER PCB | | | 001 | 0 | 0 |
| 35 | 90002-Z0D-000 | BOULON DE BRIDE, 6MM | | | 001 | 0 | 0 |

| | | | | | |
|----|---------------|---------------------------|-----|---|---|
| 36 | 90301-VP7-000 | ECROU SPECIAL, 6MM | 001 | 0 | 0 |
| 37 | 93913-14220 | VIS AUTO-TARAUDEUSE, 4X12 | 004 | 0 | 0 |
| 38 | 31200-VP9-PC0 | ENS. POSTE | 001 | 0 | 0 |